

UNIVERSAL JOINTS

MOLDED TYPE

**JP SERIES
SINGLE AND DOUBLE**



MOLDED DELRIN BODY provides vibration dampening and electrical insulation.

MAX. ANGULAR DISPLACEMENT—Single 45°, Double 90°

MAX. AMBIENT TEMPERATURE—180°F

COMPLETE WITH SETSCREWS

STANDARD TOLERANCES

DIMENSION		TOLERANCE
BORE	All	+ .001 - .000

REFERENCE PAGES

Mounting—148

MATERIALS

Delrin Body
Nickel Plated Brass Spider and Insert

SINGLE

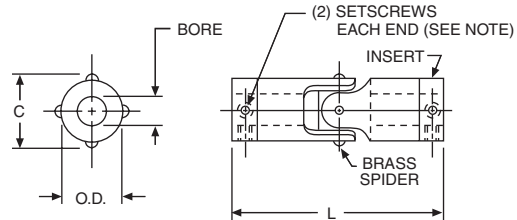

DOUBLE

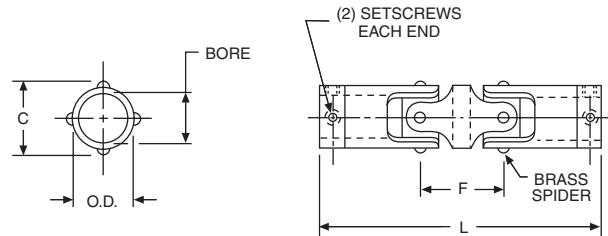

ALL DIMENSIONS IN INCHES
ORDER BY CATALOG NUMBER OR ITEM CODE

Bore	Bore Depth (Typical)	O.D.	C	L		DOUBLE ONLY			SINGLE		DOUBLE	
				Single	Double	F	Max. Parallel Offset	Setscrew	Catalog Number	Item Code	Catalog Number	Item Code
1/8	.39	1/4	.27	1-3/64	1-23/64	5/16	.22	#4-40	JP25-1/8*	54194	JPD25-1/8	54202
1/8	.52	3/8	.41	1-31/64	2	17/32	.36	#4-40	JP37-1/8*	54195	JPD37-1/8	54203
3/16									JP37-3/16	54196	JPD37-3/16	54204
3/16	.63	1/2	.54	1-13/16	2-7/16	5/8	.43	#6-32	JP50-3/16	54197	JPD50-3/16	54205
1/4									JP50-1/4	54198	JPD50-1/4	54206
1/4	.86	5/8	.68	2-41/64	3-33/64	7/8	.61	#8-32	JP62-1/4	54199	JPD62-1/4	54207
5/16									JP62-5/16	54200	JPD62-5/16	54208
3/8									JP62-3/8	54201	JPD62-3/8	54209

*One setscrew each end.

LOAD DATA

Basic Size	Maximum Torque† (Lb. Ins.)	
	Single	Double
25	5	2.5
37	16	7
50	26	12
62	60	47

†This is the ultimate or breaking torque for static, zero angle conditions. Actual operating conditions will dictate use of significantly lower values.